



# VIC Title Diagram

ORDER NUMBER . 8041226035

12/12/2016 11:13 AM

IB.com.au

SAMPLE

**ORIGINAL**

**NOT TO BE TAKEN FROM THE OFFICE  
OF TITLES**



VICTORIA

**CANCELLED**  
REGISTER BOOK

VOL. 8590 FOL. 407

# Certificate of Title

UNDER THE "TRANSFER OF LAND ACT"

EVANGELOS LADAS and STAVROS BOICOS both of 346 Russell Street Melbourne

Businessmen are now the joint proprietors of an estate in fee simple subject to the encumbrances notified hereunder in ALL THAT piece of land delineated

and coloured red and blue on the map on the sheet annexed hereto being

Lots 46 to 59 (both inclusive) on Plan of Subdivision No. 21832 Parish of

Djerriwarrh County of Bourke

**TEST DATA ONLY**

DATED the 3rd day of 9

Assistant Registrar of Titles



## ENCUMBRANCES REFERRED TO

As to the land coloured blue  
THE EASEMENTS (if any) existing over the same by virtue of Section 98 of the Transfer of Land Act

Delivered on-line by LANDATA®

IMAGED FOLIO - WARNING: TO BE USED FOR DIAGRAM, EASEMENT INFORMATION, DEPTH LIMITATIONS AND ANY DIAGRAM NOTATIONS. The text of this Folio has been converted to a computer Folio and the effect of any dealing registered since the text conversion will appear on the computer Folio.

Derived from Vols. 3344 Fols. 686

8300 352

C25729

MEASUREMENTS ARE IN

VOL. 8590 FOL. 407

TRANSFER AS TO PART No. C 54759  
registered 9<sup>th</sup> October 1964

CANCELLED AS TO PART

See Vol 8590 Fol. 410

lots 54+55



TRANSFER AS TO PART No. C 59832  
registered 15<sup>th</sup> October 1964

CANCELLED AS TO PART

See Vol 8590 Fol. 411

lot 47.



TRANSFER AS TO PART No. C 101100  
registered 4<sup>th</sup> December 1964

CANCELLED AS TO PART

See Vol 8590 Fol. 413

lot 59.



TRANSFER AS TO PART No. C 110720  
registered 16<sup>th</sup> December 1964

CANCELLED AS TO PART

See Vol. 8590 Fol. 415

lots 56 + 57.



TRANSFER AS TO PART No. C 237306  
registered 9<sup>th</sup> JUNE 1965

CANCELLED AS TO PART

See Vol. 8613 Fol. 570

Lot 50



TRANSFER AS TO PART No. C 237306  
registered 9<sup>th</sup> JUNE 1965

CANCELLED AS TO PART

See Vol. 8613 Fol. 571

Lot 51



TRANSFER AS TO PART No. C 303434  
registered 1<sup>st</sup> SEPTEMBER 1965

CANCELLED AS TO PART

See Vol. 8613 Fol. 572

Lot 58



TRANSFER AS TO PART No. C 738012  
registered 31 March 1967

CANCELLED AS TO PART

See Vol 8679 Fol. 917

Lot 53



TRANSFER AS TO PART No. D 642104  
registered 18<sup>th</sup> February 1970

CANCELLED AS TO PART

See Vol 8817 Fol. 201

LOT 52



TRANSFER AS TO PART No. F 12911  
registered 28<sup>th</sup> February 1975

CANCELLED AS TO PART

See Vol. 9083 Fol. 441

lot 43



CAVEAT No G 611054 LODGED = 4 MAY 1977

Affecting part of the land herein Lot No. 46 P/S 51832

TEST DATA ONLY

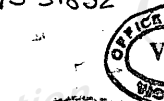

TRANSFER AS TO PART No. H 176118  
registered 1<sup>st</sup> August 1978

CANCELLED AS TO PART

See Vol. 9297 Fol. 557

lot 49



Evangelos Ladas is now the  
surviving proprietor

Registered 1<sup>st</sup> August 1979

No H 648233



TRANSFER AS TO BALANCE No. H 648234  
registered 1<sup>st</sup> August 1979

CANCELLED See Vol. 9350 Fol.

675



T08590-407-1-1

CANCELLED

DELIVERED TO THE REGISTRAR FOR THE OFFICE OF TITLES, VICTORIA. THIS DOCUMENT IS NOT VALID UNLESS IT IS SIGNED BY THE REGISTRAR OR HIS DEPUTY. IT IS THE RESPONSIBILITY OF THE REGISTRAR TO ENSURE THAT THE DOCUMENT IS SIGNED BY THE APPROPRIATE OFFICER.

ANNEXED SHEET REFERRED TO IN  
CERTIFICATE OF TITLE VOL 8590 FOL. 407

Assistant Registrar of Titles

**SAMPLE**

Delivered  
on-line by  
LANDATA®

IMAGED FOLIO - WARNING: TO BE USED FOR DIAGRAM, EASEMENT  
INFORMATION, DEPTH LIMITATIONS AND ANY DIAGRAM NOTATIONS.  
The text of this Folio has been converted to a computer Folio and the effect of any  
dealing registered since the text conversion will appear on the computer Folio.



MEASUREMENTS ARE IN  
FEET AND INCHES.

Sample

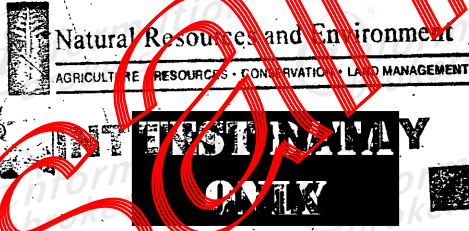

Delivered by LANDATA®. WARNING: TO BE USED FOR DIAGRAM, SCHEMATIC, PRINTING OR OTHER PURPOSES. The text of this file has been converted to a computer file and the effect of any editing registered since the text conversion will appear on the computer file.

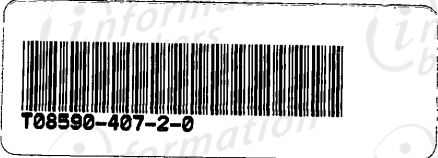

SCALE: 100 FEET to one inch

Volume 8590 Folio 407

METRIC MEASUREMENTS

SHOWN FOR H.64.234 (BAL)

SAMPLE

TEST DATA ONLY

Delivered on-line by LANDATA®

IMAGED FOLIO - WARNING: TO BE USED FOR DIAGRAM, EASEMENT INFORMATION, DEPTH LIMITATIONS AND ANY DIAGRAM NOTATIONS. The text of this Folio has been converted to a computer Folio and the effect of any dealing registered since the text conversion will appear on the computer Folio.

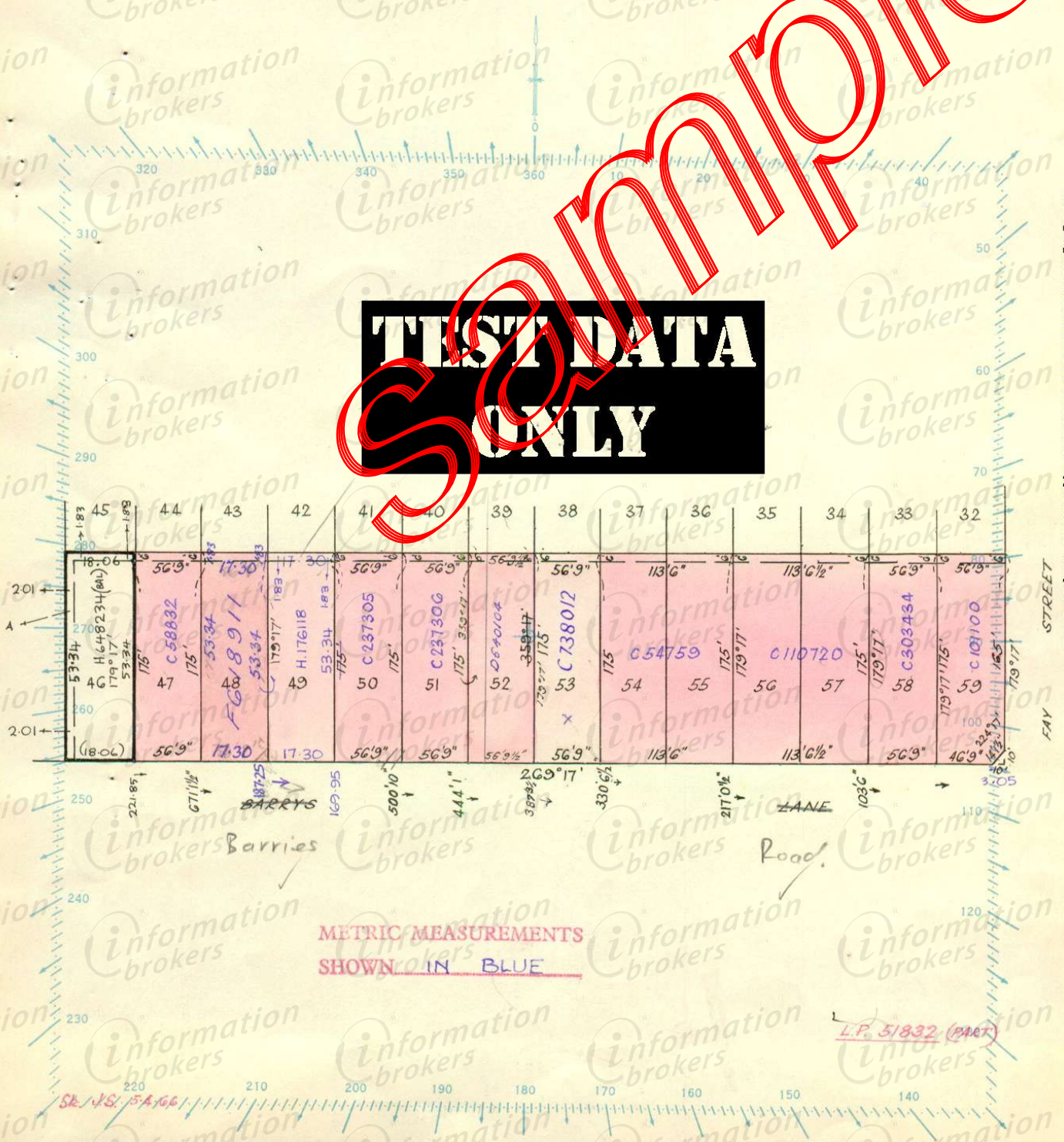

**Sample**

Natural Resources and Environment  
AGRICULTURE • RESOURCES • CONSERVATION • LAND MANAGEMENT  
**INTERNATIONALLY  
TEST DATA  
ONLY**

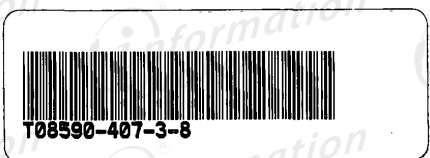

Delivered by LANDATA®. LANDATA® is a registered trademark of LANDATA®. LANDATA® is a registered trademark of LANDATA®. LANDATA® is a registered trademark of LANDATA®.